

SAVING LIVES BY DESIGN

# SAFE-HIT

## SOIL ANCHORED DELINEATORS

### OVERVIEW

Safe-Hit's complete line of durable & flexible, soil anchored posts provide delineation and enhance motorist safety on public and private roadways. Typical applications include guide posts, culvert markers, median crossovers, and mile markers.

Safe-Hit's flexible posts rebound from multiple impacts, and are constructed of durable linear low density, co-extruded polyethylene with ultraviolet inhibitors. They are available with portable bases, surface mount bases or soil anchors. Safe-Hit posts feature a two piece, self-locking system that reduces installation and maintenance costs. If the Safe-Hit post is damaged, replacement is quick and easy.

### FEATURES AND BENEFITS

- ▶ A unique two part system incorporates the use of a permanent anchor and a replaceable post.
- ▶ 1-3/4" inner tube provides superior rebound capability.
- ▶ Tubular, galvanized anchor is available in various lengths to accommodate different soil conditions.
- ▶ Posts that come in a variety of heights, shapes and colors to accommodate different reflective configurations.
- ▶ Unlike STEEL posts, these FLEXIBLE posts cause minimal damage to impacting vehicles while reducing personal injury.
- ▶ The post is easily replaced without having to reinstall the existing anchoring system.
- ▶ Numerous reflective and decal options available.



[WWW.SAFE-HIT.COM](http://WWW.SAFE-HIT.COM)

## SOIL ANCHORED POST TYPES



**TYPE 1  
HAZARD MARKER**  
Round post, flattened on top with black oval cap, three 3"(76.2m) x 3"(76.2m) reflective patches and Driveable Soil Anchor.



**TYPE 2  
GUIDE POST**  
Round post, flattened on top with black oval cap, one 3"(76.2mm) x 9"(228.6mm) reflective strip and Driveable Soil Anchor



**TYPE 3  
CHANNELIZER**  
Round post with recessed cap, one 6" (152.4mm) reflective wrap and Driveable Soil Anchor



**TYPE 5  
MARKER POST**  
Round post with recessed cap, two 3" (76.2mm) reflective wraps and Driveable Soil Anchor

## SOIL ANCHOR OPTIONS

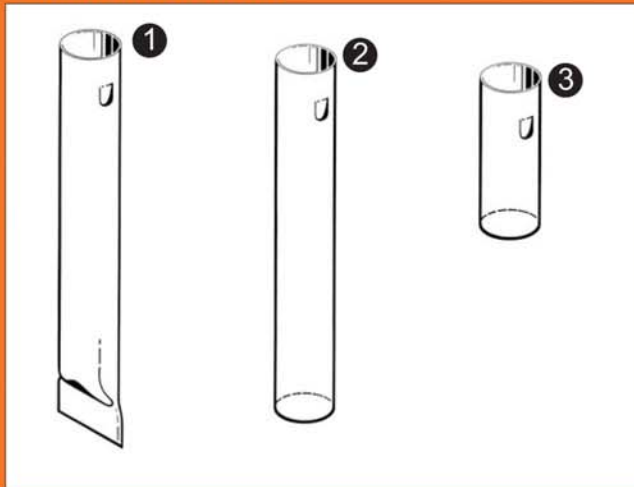

- 1 14" 18" OR 24" CLOSED END SOIL ANCHOR
- 2 14" 18" OR 24" OPEN-END SOIL ANCHOR
- 3 8" OPEN END CONCRETE ANCHOR

## SPECIFICATIONS

Overall Post Height	61 cm - 137 cm (24" - 54")
Post Diameter	5.7 cm (2.25")
Soil Anchor Lengths:	20.32 cm - 61cm (8" - 24")
Post Weight (121 cm / 48")	.68 kg (1.5 lbs)
Standard Post Colors	White, Yellow, Orange
Custom Post Colors	Light Gray, Dark Gray, Green, Blue, Black, Brown or Red
Reflective Sheeting	Standard high-intensity Silver, Amber or Orange. Other types and colors available.
Installation Tools & Accessories	<ul style="list-style-type: none"> <li>• Manual Anchor Installation Tool</li> <li>• SH-6 Drive Tool Adapter</li> <li>• Anchor Straightening Tool</li> <li>• Post Removal Tool</li> <li>• Pilot Hole Tool</li> <li>• Drive Shanks &amp; Adapters (for Jackhammer &amp; Piston Hammer power installation)</li> </ul>



Distributed By:

**SAFE-HIT®**



**ENERGY ABSORPTION  
SYSTEMS, INC.**

A Quixote Company

WWW.SAFE-HIT.COM

35 East Wacker Drive • Chicago, IL 60601  
Tel: (800) 537-8958 • Fax: (800) 770-6755  
www.quixtrans.com

General specifications for Safe-Hit Delineators are subject to change without notice to reflect improvements and upgrades. Additional information is available. Contact Safe-Hit for details.